

# LIGHT

## 2025 TRAVEL TRAILERS



43.8901° N, 102.2548° W  
Pennington County, South Dakota



*Experience the Open*







2025 Light 290RLS



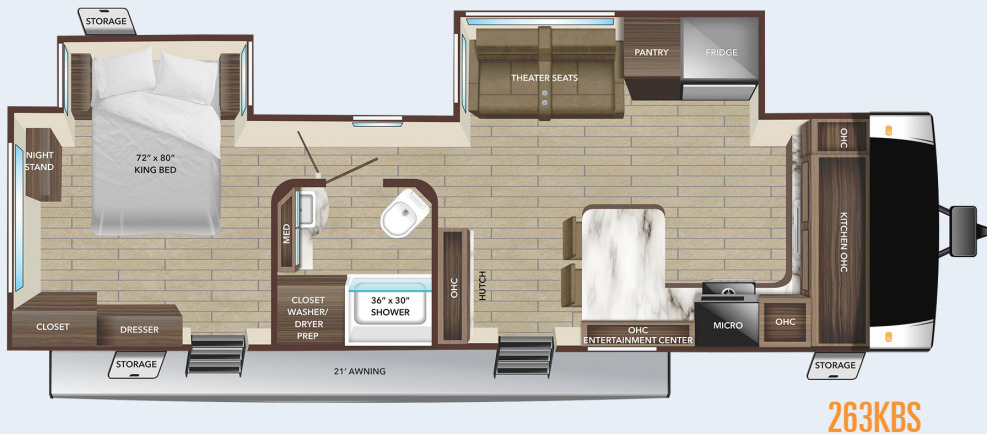
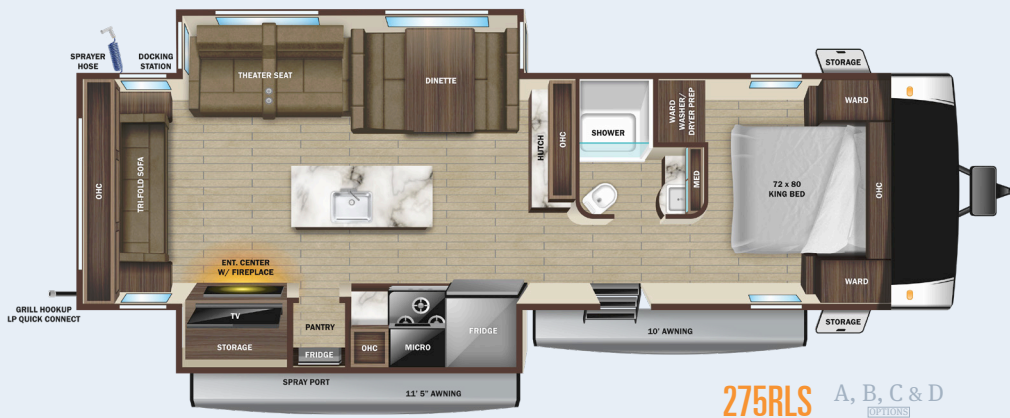

## LIGHT TT

## FLOORPLAN OPTIONS

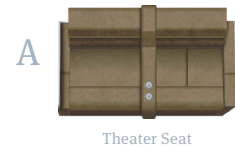

## STANDARD INTERIOR EQUIPMENT

- » 10 cu. ft. 12V refrigerator
- » 15,000 BTU roof mounted A/C
- » 5G antenna
- » 50 amp service with 2nd A/C prep
- » 75 lb. ball bearing drawer guides
- » Cable and satellite prep
- » Dome style digital TV antenna with Wi-Fi prep
- » Electrical outlets and USB ports in master bedroom
- » Flush floor slides with residential vinyl flooring
- » Glass shower doors
- » Hardwood cabinet doors
- » Hidden hinge cabinet door hinges
- » Kitchen sink covers
- » LED interior lighting
- » Magnetic cabinet door catches
- » Microwave
- » Pressed membrane countertops
- » Range hood vented outside
- » Residential high-rise faucet
- » Roller blackout night shades
- » Stainless steel single basin under-mount kitchen sink

## STANDARD EXTERIOR EQUIPMENT

- » 120 GFCI protected receptacle
- » 5/8" main floor decking
- » Class leading I-beam chassis and draw bar sizes
- » Enclosed exterior docking station with black tank flush
- » Equa-Flex® axle suspension
- » Exterior grill/griddle quick connect port
- » Fully walkable roof
- » Gas/electric water heater
- » In-frame battery rack
- » Large grab handle on main entry door
- » Magnetic baggage door catches
- » Nitrogen filled radial tires with aluminum rims
- » Power awning with LED lighting

- » Power tongue jack
- » PVC roofing membrane (limited lifetime warranty)
- » Rain guttering with molded drip spouts
- » Rear observation camera prep
- » Self-adjusting electric brakes
- » Side marker light camera prep
- » Thermal Seal- enclosed, insulated and heated underbelly and fully insulated roof with a PVC roofing membrane
- » TuffShell™ - vacuum bonded laminated construction, reinforced with heavy-duty fiberglass and welded aluminum frames
- » Xtend Solar I Package (200 watt solar panel with 30 amp solar controller)

## CUSTOMER CONVENIENCE PACKAGE (MANDATORY)

- » 3-burner range with 17" oven and flush mount glass cover
- » 72" x 80" residential style king bed
- » Keyed-Alike™ entry and baggage doors
- » Molded front cap with LED lighting and stoneguard protection
- » Pop up wireless and USB charger in bedroom
- » Smart entertainment HDTV with Bluetooth®, soundbar and built in stereo
- » TravelLINK® - Smart RV system that allows for Bluetooth® control of awnings, lighting, slideouts, heating, cooling and more

## OPTIONS

- » 2nd A/C ducted
- » 17" Griddle with bumper bracket
- » 70" theater seats ipo standard tri-fold sofa (275RLS, 290RLS)
- » Power front and rear stabilizer jacks
- » Table with 2 chairs and bench ipo standard booth
- » Table with 4 chairs ipo standard booth
- » Theater seats 70" ipo Std. Tri-Fold Sofa (275RLS, 290RLS)
- » Tri-fold sofa ipo standard theater seats (321BHS)
- » Wi-Fi router
- » Mega Lounge ipo standard theater seats and booth (275RLS, 321BHS)
- » Wi-Fi router
- » Xtend Solar II Package (2-200 watt solar panels with 30 amp solar controller and 1800 watt inverter) (Replaces standard Xtend Solar I Package)

SPECIFICATIONS <small>May Include Estimated Values</small>	290RLS	275RLS	321BHS	263KBS
Unloaded Vehicle Weight (lbs.)	7,320	7,350	8,655	7,360
Dry Hitch Weight (lbs.)	960	985	1,075	990
Gross Vehicle Weight Rating (GVWR)	8,900	8,995	9,995	8,900
Cargo (Gross)	1,580	1,645	1,340	1,540
Exterior Length (Overall)	33' 5"	33' 11"	37' 10"	32' 4"
Exterior Height	11' 2"	11' 3"	10' 9"	10' 8"
Exterior Width	8' 1"	8' 1"	8' 1"	8' 1"
Exterior Width (Slides Out)	13' 2"	13' 5"	14' 2"	11' 4"
Interior Height (Overall)	6' 9"	6' 9"	6' 9"	6' 9"
Fresh Water Capacity (Gal.)*	51	51	51	51
Gray Waste Water Capacity (Gal.)	58	58	58	58
Black Waste Water Capacity (Gal.)	29	29	29	29
LP Capacity (lbs.)	60	60	60	60
Tire Size	15"	15"	15"	15'
Awning Size	11', 10'	11' 5", 10'	11', 10'	21'

\*Includes Water Heater

### LOCAL DEALER INFO

TO LEARN MORE VISIT  
[openrangerv.com](https://openrangerv.com)



Highland Ridge RV – Part of the Jayco Family of Companies



**Highland**  
RIDGE RV

Own the Outdoors

Due to continual research and advances, manufacturer reserves the right to change specifications, design, price, and equipment without notice, and assumes no responsibility for any error in the literature. Some items shown are not included as standard or optional equipment.